Grand Valley State University

Supercomputing 2008 Education Program Summer Workshop

Contact Information

Greg Wolffe	Christian Trefftz
wolffe@gvsu.edu	trefftzc@gvsu.edu
(616) 331-3884	(616) 331-3646

Proposal

We would like to formally submit a proposal to host a Summer Workshop associated with the Education Program of the Supercomputing 2008 conference.

Workshop Topic

We could host either of the following workshops, although we have a strong preference for the first option:

- 1) Parallel and Cluster Computing
- 2) Computational Biology for Biology Educators

Workshop Dates

We could host a workshop on any of the following dates, although we have a preference for the first option:

- 1) June 1-7
 - 2) July 6-12, or July 13-19, or July 20-26
-

Venue / Facilities

We propose hosting the workshop at Grand Valley's "downtown" campus, specifically in the new John C. Kennedy Hall of Engineering, located in Grand Rapids, Michigan (see location #7 on attached map). The downtown venue provides walking access to numerous administrative, recreational, and dining resources.

We have made arrangements to have two 30-seat dedicated classrooms available. These rooms have individual power outlets at each table (for laptops), and the usual instructor station tools (computer, laptop hookup, data projector, overhead projector). We will also have exclusive use of a break/dining room.

The campus is entirely wireless, and we will arrange to provide Internet access to workshop participants. We can provide dedicated access to computing clusters (Fedora linux), a 14-node blade server (Fedora linux), and two 4-core multiprocessors (Fedora linux and Windows Server 2003). We can offer two options for lab facilities:

- 1) A dedicated computer lab with 30 modern, dual-boot workstations.
- 2) A group of 20 modern dual-boot laptops for the exclusive use of participants for the duration of the workshop.

We can install any desired software on these machines. There will be on-site technical support available throughout the workshop.

There is no charge for any of the classroom or lab facilities, or for support.

Housing

We have arranged for participants to be housed at Winter Hall (see location #10 on attached map), less than a 5-minute walk from the Engineering building. The housing consists of fully-furnished efficiency-type apartments, with private bedrooms (see floor plan below).

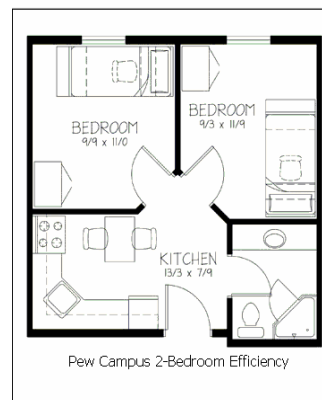

Winter Hall is air-conditioned, and includes an on-site workout facility. Free parking is available near the dorm. Spouses and children accompanied by parents can be accommodated for modest additional cost.

Meals

We have arranged for on-site catering in the break/dining room, with meals and refreshments as specified in the Organization Information document. We have arranged for the Friday night banquet at a local conference facility within easy walking distance.

Miscellaneous

The School of Computing & Information Systems and the Padnos College of Engineering and Computing have agreed to serve as sponsors for the workshop. In addition to providing free access to classrooms, lab facilities, and technical support, they will be providing clerical support (copying, printing) and all local labor necessary for coordinating the workshop. They are also making a financial donation to cover some food expenses, beverage (wine, beer) costs for the banquet, and various other support costs.

Publicity

Grand Valley State University is a designated Regional Math & Science Center, serving 36 public school districts in West Michigan. Numerous public and private colleges and universities are within driving distance. We believe there is both a wide pool of institutions and sufficient interest to attract participants to this location.

Budget

The following preliminary budget assumes maximum non-local attendance.

Income		
Base		\$4,000
Stipend	\$400	
Participants	20	\$8,000
Instructors	4	\$1,600
GVSU Sponsorship		\$2,000
Total		\$11,600

Housing		
Room-2	\$45	\$3,240
Nights	6	
Total		\$3,240

Food			
Breakfast	6	\$7.90	\$1,411
Lunch	5	\$10.50	\$1,562
Dinner	4	\$19.95	\$2,375
Banquet	1	\$24.95	\$743
Breaks	10	\$5.00	\$1,488
Total			\$7,578

Bottom-line **\$782**